

YOKE TURNED 90°

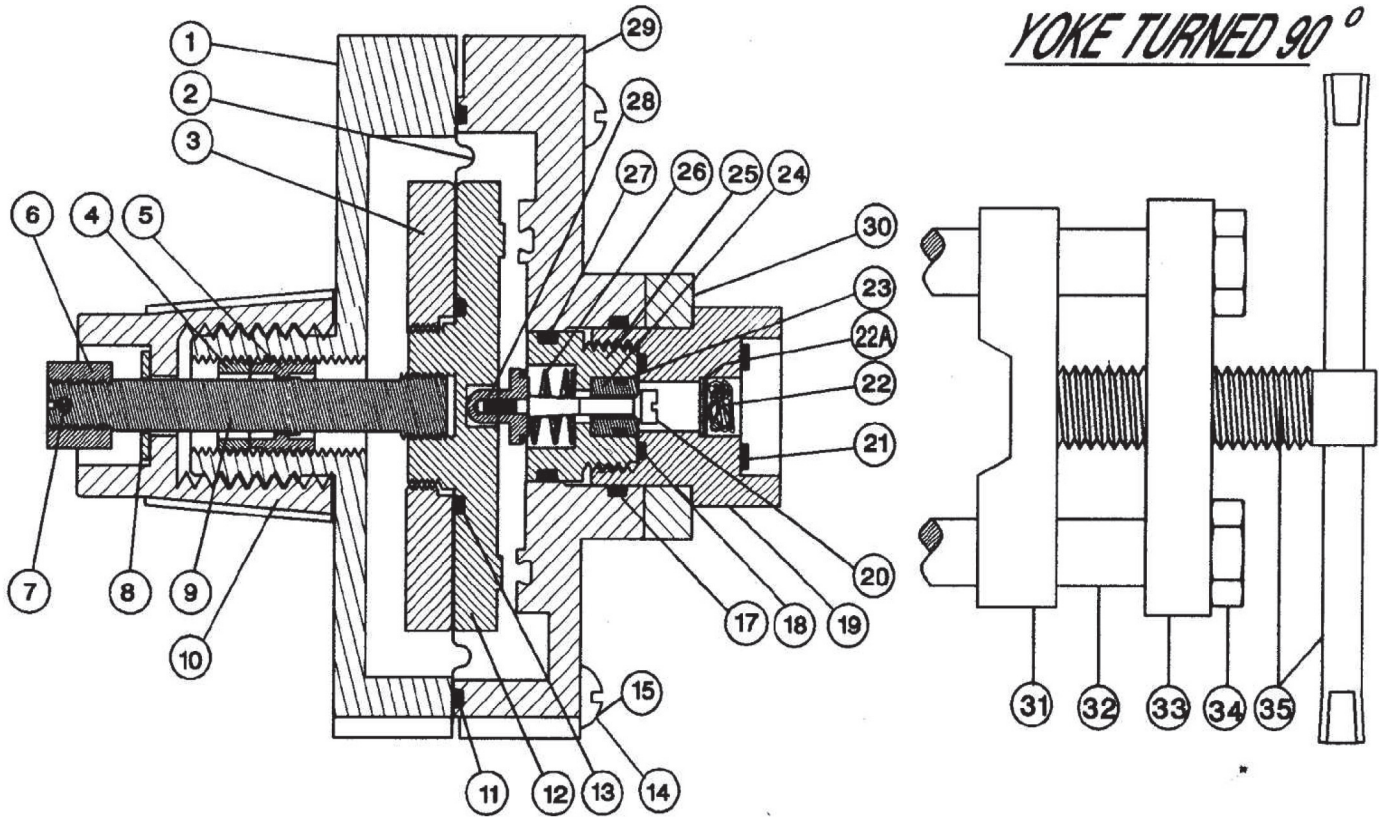

NOTE: #36 NOT SHOWN

REF NO.	QTY	DESCRIPTION	PART NO.	REF NO.	QTY	DESCRIPTION	PART NO.
1	1	VACUUM REGULATOR FRONT BODY	VR-126	21	10	LEAD GASKET	GK-150
2	1	VACUUM REGULATOR DIAPHRAGM	VR-131	22	1	FILTER - FIBERGLASS	YK-168
3	1	DIAPHRAGM FRONT PLATE	VR-150	22A	1	FILTER SUPPORT	YK-167
4	1	S/O POPPET RETAINER LOCKING RING	SP-139	23	1	INLET VALVE SEAT O-RING	OR-115
5	1	SWITCHOVER POPPET RETAINER	SP-137	24	1	INLET VALVE SEAT	IV-911
6	1	LOCKING NUT	SP-165	25	1	INLET ADAPTOR PLUG	IV-920
7	1	LOCKING PIN	SP-168	26	1	INLET SPRING	IV-160
8	1	FRICTION WASHER - TEFLON	SP-160	27	1	INLET ADAPTOR PLUG O.D. O-RING	OR-106
9	1	SWITCHOVER POPPET SHAFT	SP-145*	28	1	INLET SPRING GUIDE/VENT PLUG	IV-945
10	1	SWITCHOVER RESET KNOB	SP-134	29	1	VACUUM REGULATOR BACK BODY, UP TO 2000 PPD (40 KG/HR)	VR-910
11	1	DIAPHRAGM BODY O-RING	OR-108	30	1	YOKE BODY BAR	YK-100*
12	1	DIAPHRAGM BACK PLATE	VR-143*	31	1	YOKE SLIDE BAR	YK-130
13	1	DIAPHRAGM PLATE O-RING	OR-107	32	2	YOKE STUD	YK-120*
14	2	VAC. REGULATOR BODY/YOKE BOLT	VR-170	33	1	YOKE ROD BAR	YK-112
15	4	VAC. REGULATOR BODY BOLT	VR-171	34	2	YOKE JAM NUT	YK-110
17	1	SECONDARY INLET SAFETY O-RING	OR-113	35	2	YOKE SCREW/HANDLE	YK-160
18	1	RATE VLV SEAT/ADAPTOR FACE O-RING	OR-103	36	1	1" NPT X 1" NPT, PVC UNION WITH VITON O-RING SEAL	TU-950
19	1	INLET ADAPTOR	YK-950				
20	1	INLET VALVE PLUG	IV-930				

*NOTE: SP-145 AND VR-143 ARE ASSEMBLED AS VR-146

**NOTE: YK-100 AND YK-120 ARE ASSEMBLED AS YK-115



**CHEMICAL INJECTION
TECHNOLOGIES**

**AUTO-SWITCHOVER VACUUM REGULATOR
MODEL VR-1016**

BY: HPS

DATE: 1 OCT '05

SCALE: NTS

DWG NO:VR-1016

**VR-1016
VACUUM
REGULATOR**

